

## Morse Academic Building Belmont Hill School Belmont, MA

Client: Belmont Hill School

Contact: Gary Hall, Business Manager

Phone: 617. 484.4410



The project site is located on the 32 acre campus of the Belmont Hill School in Belmont, MA. The Morse Academic Building is 10,000 sf academic building constructed in 1945. The building required a complete renovation as well as the addition of an 8,000 sf wing. As is the problem with much of the school campus, it lies in an area that has historically had drainage problems due to the topography and soils. The work was limited by the school schedule and the construction had to take place during school vacations. Coordination was essential since this only left a construction window of approximately 100 days, which was met.

BCG prepared the base mapping for the project area, to include underground utility location and topographic mapping of the site. It also provided civil engineering services. The scope included designing the following utilities: drainage, electric/fiber optic, gas, domestic and fire protection water, and sewer. The site required a storm water management system that eliminated the existing drainage problems in the quadrangle area and that also addressed the construction of the new building. BCG provided construction surveying services and also provided construction overview for the construction of the utilities.

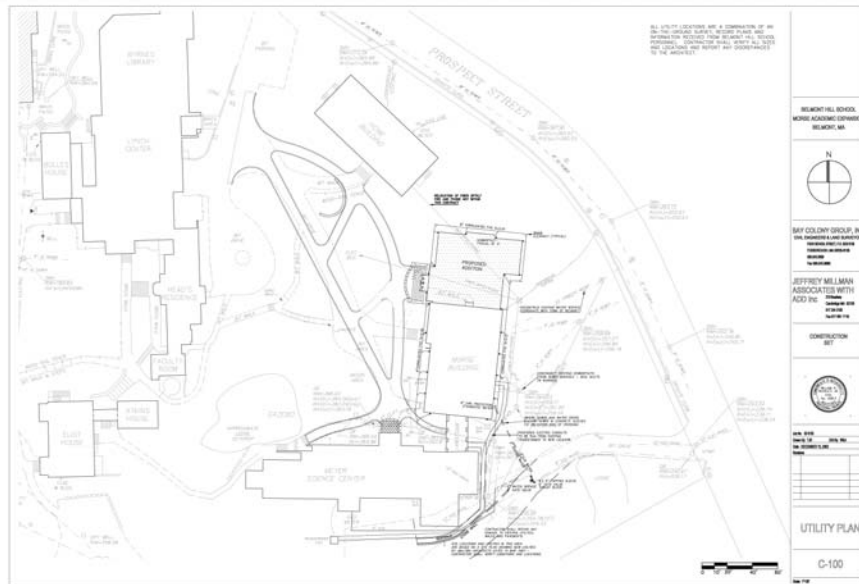

The project was completed in 2003.